

DETAIL A  
EXHAUST OUTLETS  
SCALE 0.50

NOTE: DIMENSIONS IN [ ] ARE  
ENGLISH STANDARD EQUIVALENTS

300/250 MODEL, 4UA10/4UA13  
RECONNECTABLE,  
IMPROVED MOTOR STARTING (IMS) RECONNECTABLE  
& 600 VOLT ALTERNATORS  
14.6 LITER DOOSAN, EPA/NON-EPA

REV	DATE	ON COMPOSITE DWGS. SEE PART NO. FOR REVISION LEVEL	BY	UNLESS OTHERWISE SPECIFIED - 1) DIMENSIONS ARE IN MILLIMETERS 2) TOLERANCES ARE:	SURFACE FINISH MAX. THIRD ANGLE PROJECTION	TITLE	
-	1-14-11	NEW DRAWING [90373-3]	AWK			<b>KOHLER CO.</b>	<b>METRIC</b> <b>PRO-E</b>
A	02-19-14	SEE SHEET 1 [CT72118]	SSH			POWER SYSTEMS, KOHLER, WI 53044 U.S.A.	
B	8-18-14	SEE SHEET 1 [CT89357]	SAK			THIS DRAWING IN DESIGN AND DETAIL IS KOHLER CO. PROPERTY AND MUST NOT BE USED EXCEPT IN CONNECTION WITH KOHLER CO. WORK. ALL RIGHTS OF DESIGN OR INVENTION ARE RESERVED.	
C	03-07-18	(A-4) 300/250 WAS 250 [CT184844]	SRB			TITLE	
D	2-20-19	(C-2,3) DETAIL A EXHAUST OUTLETS NOTE ADDED; (C-1) Ø90 [3.5] ADDED; SEE SHEET 1				<b>DIMENSION PRINT, 250/300 REZX</b>	
		[CT191938]	DS			SCALE 0.08	CAD NO.
			DRAWN	AWK	1-14-11	SHEET 2 of 3	
			CHECKED	CWF	1-14-11	ADV-7987	
			APPROVED	WRD	1-14-11	D	

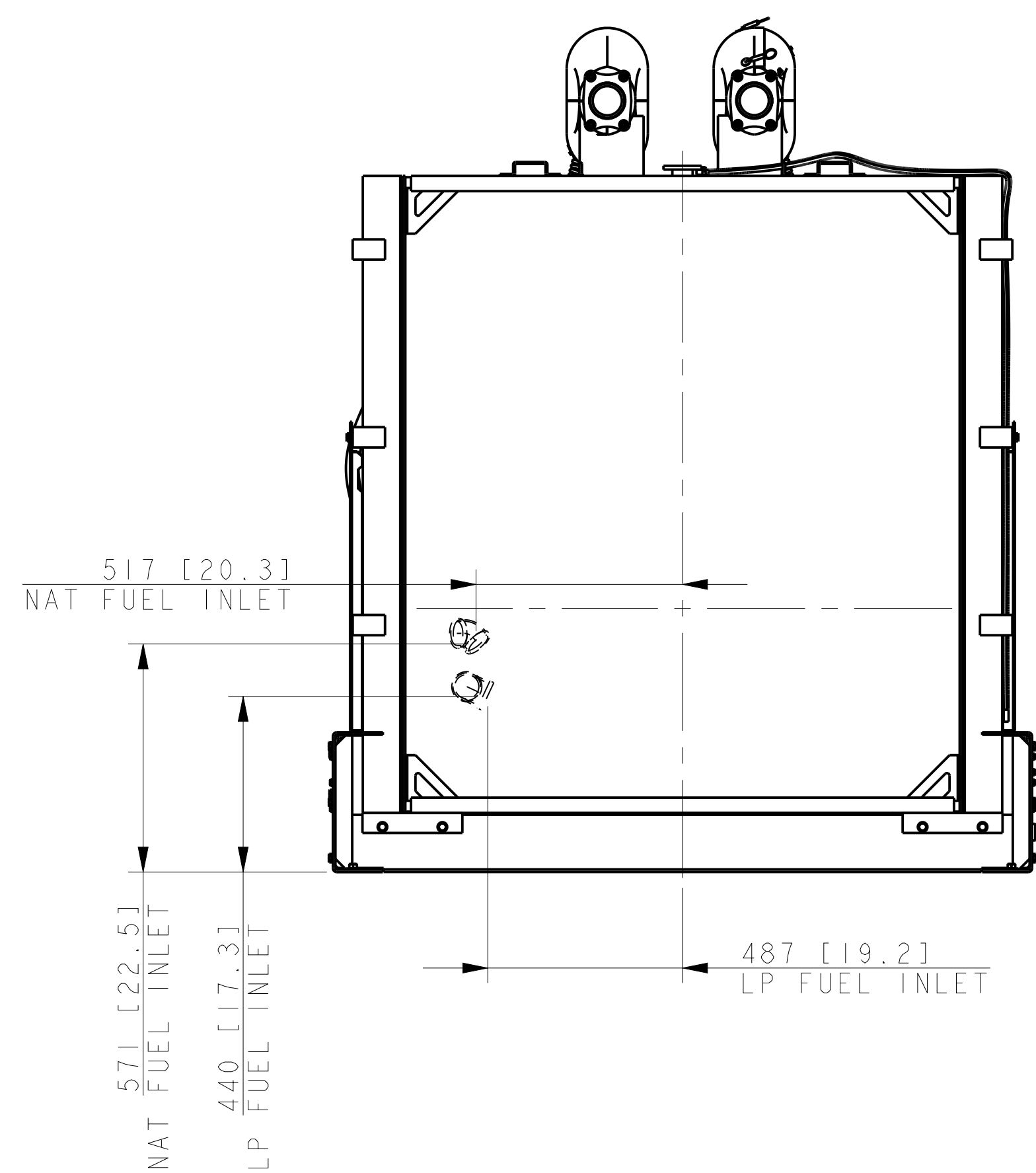
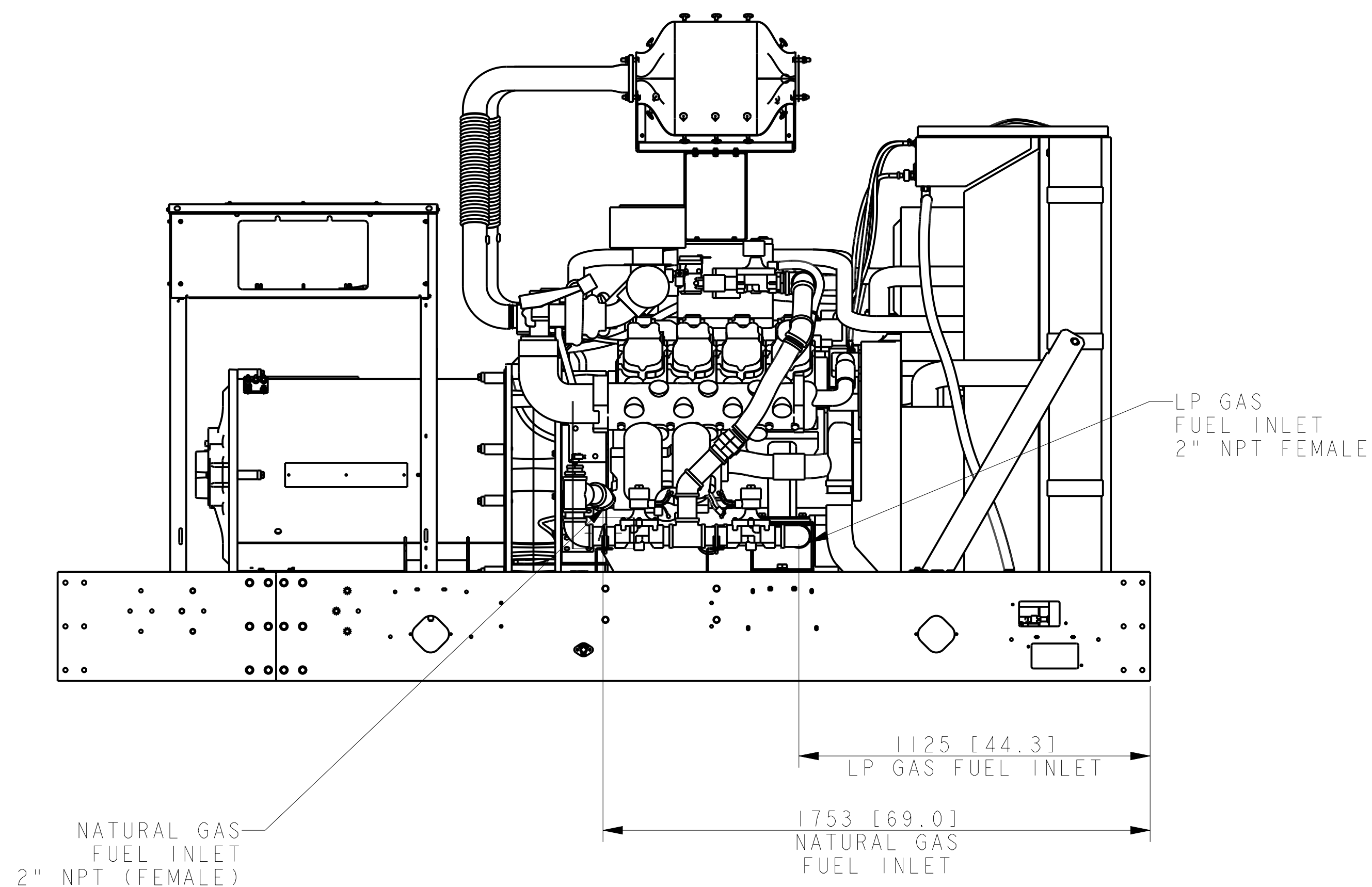
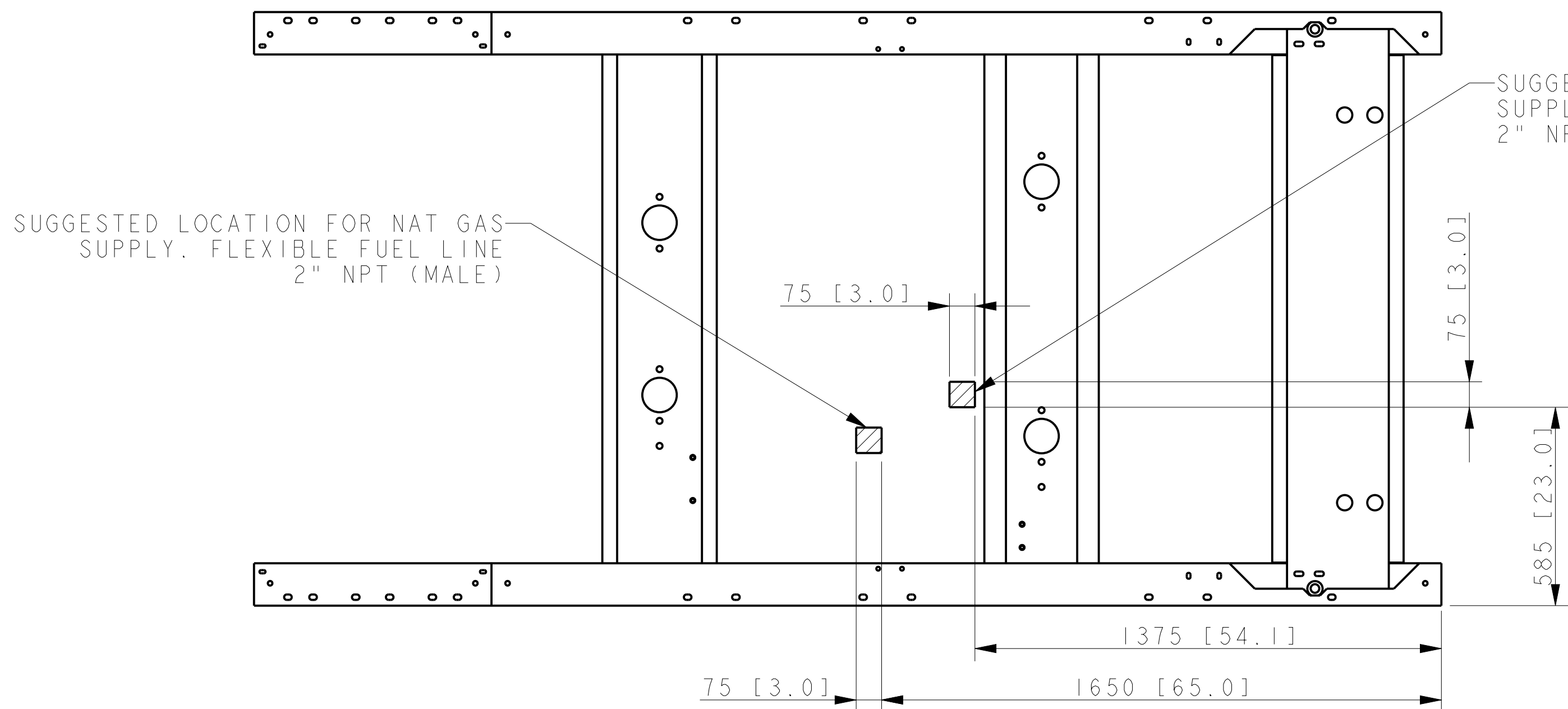

DUAL FUEL NATURAL GAS & LP GAS

NOTE: DIMENSIONS IN [ ] ARE  
ENGLISH STANDARD EQUIVALENTS

300/250 MODEL, 4UA10/4UA13  
RECONNECTABLE,  
IMPROVED MOTOR STARTING (IMS) RECONNECTABLE  
& 600 VOLT ALTERNATORS  
14.6 LITER DOOSAN, EPA/NON-EPA

REV	DATE	ON COMPOSITE DWGS. SEE PART NO. FOR REVISION LEVEL	BY	UNLESS OTHERWISE SPECIFIED - 1) DIMENSIONS ARE IN MILLIMETERS 2) TOLERANCES ARE:	TITLE	
-	1-14-11	NEW DRAWING [90373-3]	AWK		SURFACE FINISH MAX. THIRD ANGLE PROJECTION	KOHLER CO. METRIC PRO-E POWER SYSTEMS, KOHLER, WI 53044 U.S.A. THIS DRAWING IN DESIGN AND DETAIL IS KOHLER CO. PROPERTY AND MUST NOT BE USED EXCEPT IN CONNECTION WITH KOHLER CO. WORK. ALL RIGHTS OF DESIGN OR INVENTION ARE RESERVED.
A	02-19-14	SEE SHEET 1 [CT72118]	SSH			
B	8-18-14	SEE SHEET 1 [CT89357]	SAK		APPROVALS DATE DRAWN AWK 1-14-11 CHECKED CWF 1-14-11 APPROVED WRD 1-14-11	DIMENSION PRINT, 250/300 REZX
C	03-07-18	(A-4) 300/250 WAS 250 [CT184844]	SRB			
D	2-20-19	SEE SHEET 1 & 2 [CT191938]	DS			
					SCALE 0.08 CAD NO.	SHEET 3 of 3
					ADV-7987	